

28.05.2024

**J U Z U R**

# ABOUT JUZUR

Rooted in the Arabic term for “roots,” JUZUR symbolizes enduring connections and strength. As a forward-thinking real estate developer based in Cairo, Egypt, we are supported by a blend of visionary local and international investors. Our strategic approach involves carefully selecting locations and choosing development projects that promise sustainable growth and community enhancement. Each decision is driven by a commitment to creating spaces that foster connections, turning every development into a potential home for thriving relationships.

At JUZUR, we value the synergy created through diverse partnerships. The collaboration between our partners brings a rich mix of experience to the table, enhancing our projects and ensuring robust returns for our investors. We don't just build properties; we cultivate environments where every client is welcomed as a cherished member of our extended family.







# ROOTS OF DEVELOPMENT



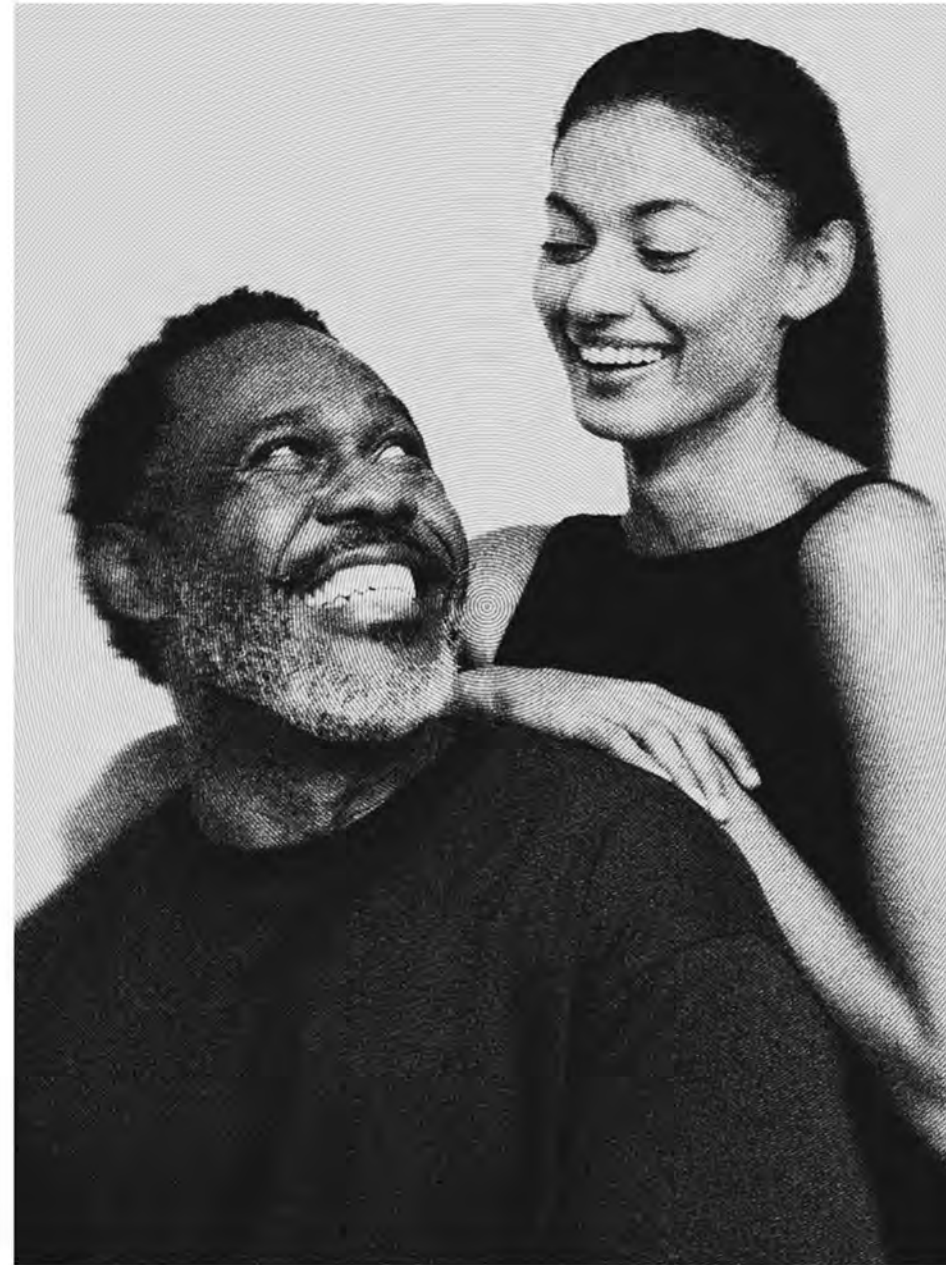

LOVE  
JOY  
PASSION  
CHARACTER  
CULTURE  
UNITY  
STANDARDS  
VALUES

**JUZUR'S 8 ROOTS OF  
DEVELOPMENT**

**ABOUT NEO**

“Enhancing value through strategic optimization of spaces within mixed-use venues to facilitate the growth and success of businesses.”



NEO, JUZUR's new commercial project is a visionary endeavor that encapsulates the essence of modernity and innovation. Inspired by the Greek word "neos," meaning new, and drawing from the futuristic concept of "The Matrix," this project aims to redefine the urban landscape by infusing it with a contemporary flair. Central to this development are dynamic screens adorning the buildings, seamlessly integrating sleek architectural design with cutting-edge digital technology. These screens not only serve as aesthetic marvels but also functionally enhance the environment by offering advertising opportunities, interactive displays, and real-time information updates. NEO represents a bold step towards creating an immersive and visually captivating commercial space that pushes the boundaries of traditional urban design













SIGNAGE

SIGNAGE

SIGNAGE

SIGNAGE

SIGNAGE

SIGNAGE

SIGNAGE

SIGNAGE

SIGNAGE

SIGNAGE

SIGNAGE

SIGNAGE

SIGNAGE

SIGNAGE

60 YEARS OF HISTORY



Get in on the Action Busion







NEO

JUST  
DO  
IT.



SIGNAGE

SIGNAGE

SIGNAGE

SIGNAGE

SIGNAGE

SIGNAGE

SIGNAGE

SIGNAGE

SIGNAGE

SIGNAGE

NEO







NEO

**JUST DO IT.**  
"AIR"  
NIKE

PATEK PHILIPPE  
GENEVE

SIGNAGE SIGNAGE SIGNAGE

Dynamic Island.  
For when things  
just pop up.

Uber  
Pickup in 3 min  
Meet at 1124 Mission St

Spartan  
PERSONALITY  
OMEGA

SIGNAGE

NEO

SIGNAGE

SIGNAGE

SIGNAGE



# FLOOR PLANS

Basement 2 Floor Plan -7.8m

□ Vertical Circulation

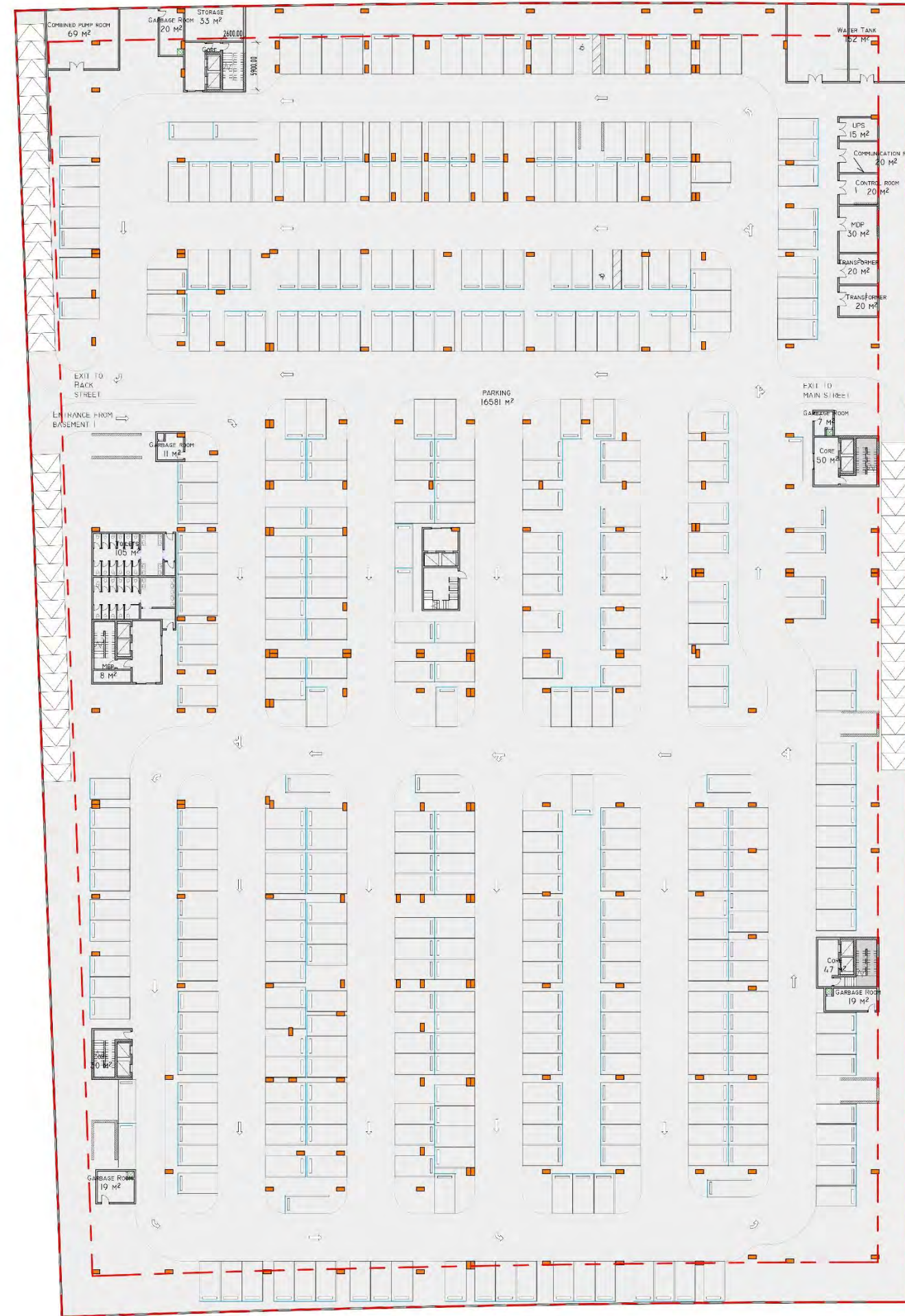



# FLOOR PLANS

Lower Ground Floor Plan -4.00m

- Entertainment
- F&B
- Car Care
- Hyper-Market
- Retail
- Toilets
- F&B/Retail
- F&B Duplex
- Retail Duplex
- Beauty Salon





# FLOOR PLANS

## Upper Ground Floor Plan 0.00m+

- Entertainment
- F&B
- Car Care
- Retail
- Toilets
- F&B/Retail
- F&B Duplex
- Retail Duplex
- Beauty Salon





# FLOOR PLANS

1<sup>st</sup> Floor Plan +5.00m

- Entertainment
- F&B
- Car Care
- Retail
- Toilets
- F&B/Retail
- F&B Duplex
- Retail Duplex
- Beauty Salon





# FLOOR PLANS

2<sup>nd</sup> Floor Plan +9.00m

- Admin
- Toilets
- Waiting area/Pantry
- Clinic





# FLOOR PLANS

3<sup>rd</sup> Floor Plan +12.60m

- Admin
- Toilets
- Waiting area/Pantry
- Clinic





# FLOOR PLANS

4<sup>th</sup> Floor Plan +12.20m

- Admin
- Toilets
- Waiting area/Pantry
- Clinic





**inland**<sup>®</sup> Properties  
Group



 [ipgegypt.com](http://ipgegypt.com)

 01003366453